

# Hard Drawn Reinforcing Mesh

**147/10 NI**

## Mesh Specification

Product Description: 5.0m x 2.24m — 300 x 300 Grid D7.5 Line Wire, D7.5 Cross Wire

	Wire Dia. (mm)	Spacing (mm)	Length (mm)	No. of Wires	Overhangs (mm)		mm <sup>2</sup> /m	Wire kg/m	Weight (kg)
<b>Longitudinal Wire</b>	7.5 D	300	5000	6	50	50	147.3	0.3468	10.40
<b>Edge Wire</b>	5.3 D	50	5000	4	50	50		0.1737	3.46
<b>Cross Wire</b>	7.5 D	300	2240	19	20	20	147.3	0.3468	14.76

**GROSS SHEET WEIGHT (Kg):** 28.63

**MASS PER SQ METER (Kg/m<sup>2</sup>):** 2.312

## Mesh Sketch (not to scale)

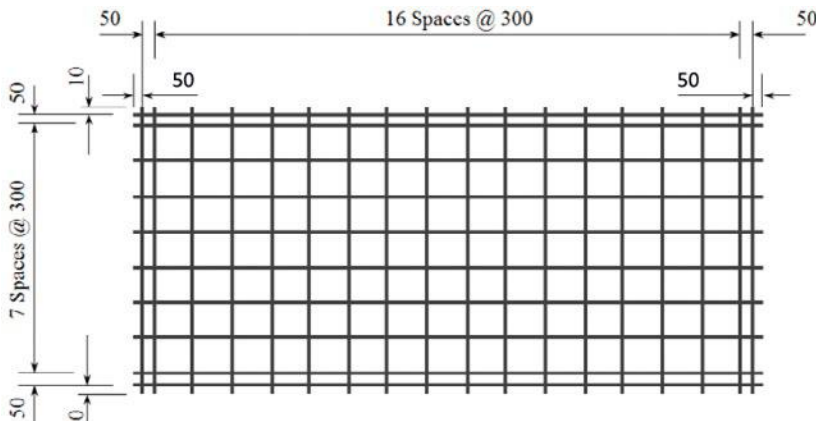

GROSS SHEET AREA (m <sup>2</sup> )	11.20
NETT COVER (m <sup>2</sup> )	10.08
Ratio STACK & TURNED (Y/N):	Y
No. OF SHEETS / BUNDLE:	25
ESTIMATED CUBIC (m <sup>3</sup> ) BUNDLE	2.4
BUNDLE WEIGHT (KG):	715

## Mechanical Properties

Wire Diam	0.2% Proof Stress	
	Min	Max
7.50 D	485MPa	750MPa

### LAPPING ON ENDS

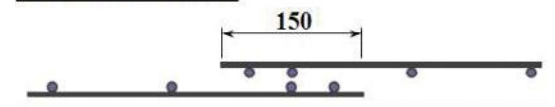

### LAPPING ON SIDES

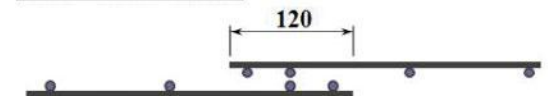

\*All measurements/weights approximate.

