

# Seismic Grade Reinforcing Mesh

## SE92DE SI

### Mesh Specification

Product Description: 6.435m x 2.38m — 200 x 200 Grid R9.0 Line Wire, R9.0 Cross Wire

	Wire Dia. (mm)	Spacing (mm)	Length (mm)	No. of Wires	Overhangs (mm)	mm <sup>2</sup> /m	Wire kg/m	Weight (kg)
Longitudinal Wire 1	9.0 R	200	6435	10	37 37	318.1	0.4994	32.17
Longitudinal Wire 2	6.1 R	80	6435	4	37 37		0.2294	5.92
Cross Wire	9.0 R	200	2380	34	10 10	318.1	0.4994	40.45
<b>GROSS SHEET WEIGHT (Kg):</b>								78.54
<b>MASS PER SQ METER (Kg/m<sup>2</sup>):</b>								4.994

### Mesh Sketch (not to scale)

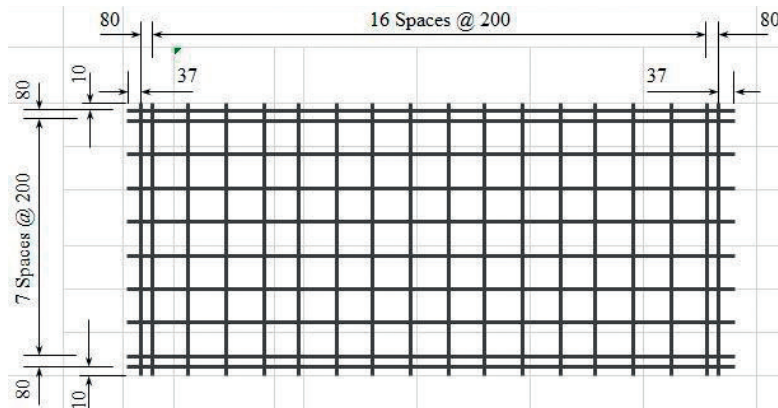

GROSS SHEET AREA (m <sup>2</sup> )	15.315
NETT COVER (m <sup>2</sup> )	13.58
Ratio STACK & TURNED (Y/N):	Y
No. OF SHEETS / BUNDLE: 2	25
ESTIMATED CUBIC (m <sup>3</sup> )	0.2068
BUNDLE WEIGHT (Tonnes):	1.9635

### Mechanical Properties

Uniform Elongation %	Yield Strength		Tensile Ratio		Weld Shear Strength
	Min	Max	Min	Max	
≥ 10 %	500MPa	600MPa	1.15	1.4	> 12.5

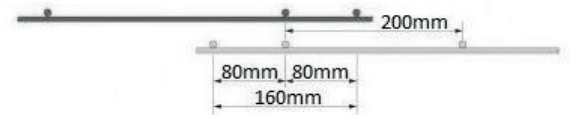

Product is fully tested for Grade 500E compliance as per AS/NZS 4671:2001  
\*All measurements/weights approximate.

