

# Seismic Grade Reinforcing Mesh

# SE82DE SI

## Mesh Specification

Product Description: 6.425m x 2.37m — 200 x 200 Grid R8.0 Line Wire, R8.0 Cross Wire

	Wire Dia. (mm)	Spacing (mm)	Length (mm)	No. of Wires	Overhangs (mm)	mm <sup>2</sup> /m	Wire kg/m	Weight (kg)
Longitudinal Wire 1	8.0 R	200	6425	10	37 37	251.3	0.3946	25.38
Longitudinal Wire 2	5.5 R	75	6425	4	37 37		0.1865	4.81
Cross Wire	8.0 R	200	2370	34	10 10	251.3	0.3946	31.84
<b>GROSS SHEET WEIGHT (Kg):</b>								62.03
<b>MASS PER SQ METER (Kg/m<sup>2</sup>):</b>								3.946

## Mesh Sketch (not to scale)

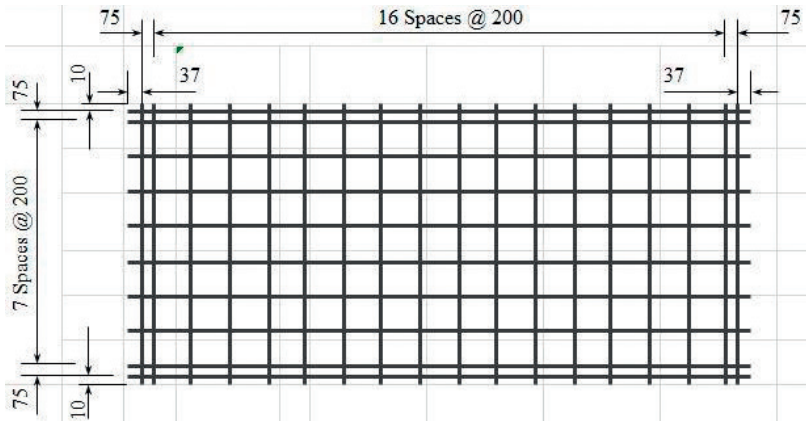

GROSS SHEET AREA (m <sup>2</sup> )	15.227
NETT COVER (m <sup>2</sup> )	13.642
Ratio STACK & TURNED (Y/N):	Y
No. OF SHEETS / BUNDLE: 2	25
ESTIMATED CUBIC (m <sup>3</sup> )	0.1827
BUNDLE WEIGHT (Tonnes):	1.5507

## Mechanical Properties

Uniform Elongation %	Yield Strength		Tensile Ratio		Weld Shear Strength
	Min	Max	Min	Max	
≥ 10 %	500MPa	600MPa	1.15	1.4	> 12.5

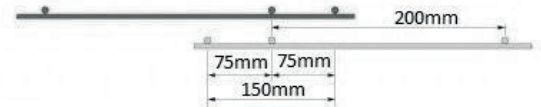

Product is fully tested for Grade 500E compliance as per AS/NZS 4671:2001  
\*All measurements/weights approximate.

