

Seismic Grade Reinforcing Mesh

SE62 Res

Mesh Specification

Product Description: 5.05m x 2.02m — 200 x 200 Grid R6.1 Line Wire, R6.1 Cross Wire

	Wire Dia. (mm)	Spacing (mm)	Length (mm)	No. of Wires	Overhangs (mm)	mm ² /m	Wire kg/m	Weight (kg)
Longitudinal Wire	6.1 R	200	5050	11	25 25	146.1	0.2294	12.74
Cross Wire	6.1 R	200	2020	26	10 10	146.1	0.2294	12.05

GROSS SHEET WEIGHT (Kg): 24.79

MASS PER SQ METER (Kg/m²): 2.294

Mesh Sketch (not to scale)

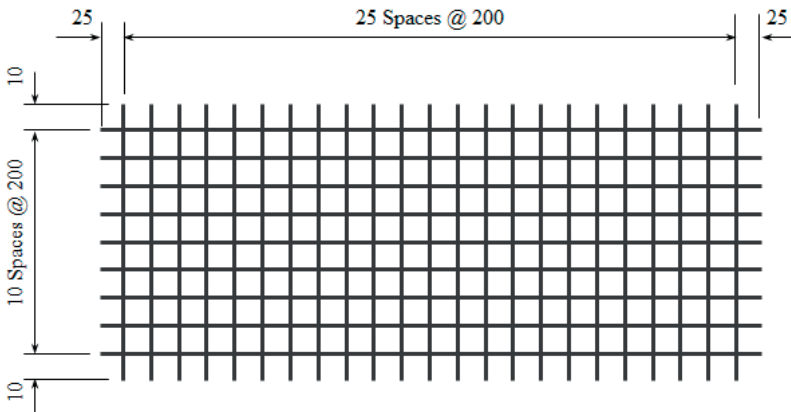

GROSS SHEET AREA (m ²)	10.201
NETT COVER (m ²)	8.312
Ratio STACK & TURNED (Y/N):	Y
No. OF SHEETS / BUNDLE: 2	25
ESTIMATED CUBIC (m ³)	0.0933
BUNDLE WEIGHT (Tonnes):	0.6198

Mechanical Properties

Uniform Elongation %	Yield Strength		Tensile Ratio		Weld Shear Strength
	Min	Max	Min	Max	
≥ 10 %	500MPa	600MPa	1.15	1.4	7.3

LAPPING ON ENDS

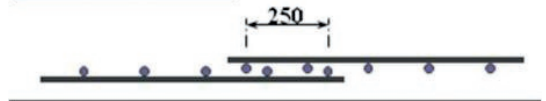

LAPPING ON SIDES

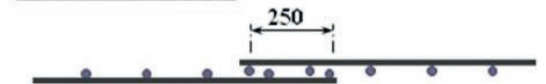

Mesh App:

Download our free smart-phone app by visiting the Apple or Google stores. Alternatively, scan the QR code from your phone to download directly.

