

Seismic Grade Reinforcing Mesh

SE82

Mesh Specification

Product Description: 5.65m x 2.22m — 200 x 200 Grid R8.0 Line Wire, R8.0 Cross Wire

	Wire Dia. (mm)	Spacing (mm)	Length (mm)	No. of Wires	Overhangs (mm)	mm ² /m	Wire kg/m	Weight (kg)
Longitudinal Wire	8.0 R	200	5650	12	25 25	251.3	0.3946	26.75
Cross Wire	8.0 R	200	2220	29	10 10	251.3	0.3946	25.40

GROSS SHEET WEIGHT (Kg): 52.16

MASS PER SQ METER (Kg/m²): 3.946

Mesh Sketch (not to scale)

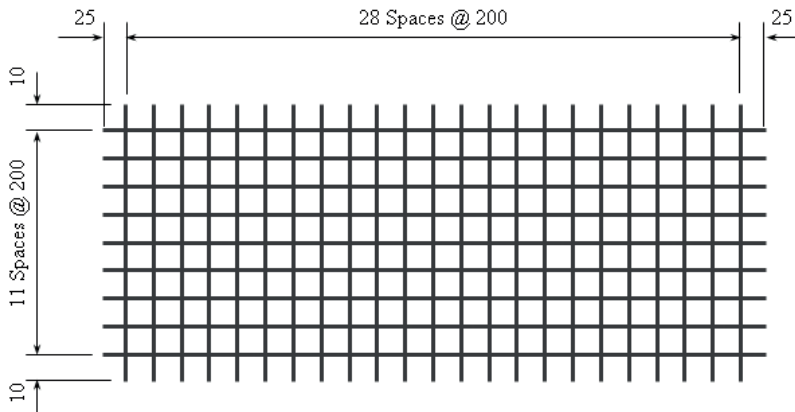

GROSS SHEET AREA (m ²)	12.543
NETT COVER (m ²)	10.432
Ratio STACK & TURNED (Y/N):	Y
No. OF SHEETS / BUNDLE: 2	25
ESTIMATED CUBIC (m ³)	2.6089
BUNDLE WEIGHT (Tonnes):	1.3040

Mechanical Properties

Uniform Elongation %	Yield Strength		Tensile Ratio		Weld Shear Strength
	Min	Max	Min	Max	
≥ 10 %	500MPa	600MPa	1.15	1.4	> 12.5

LAPPING ON ENDS

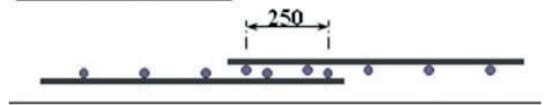

LAPPING ON SIDES

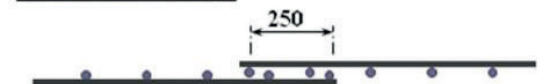

Mesh App:

Download our free smart-phone app by visiting the Apple or Google stores. Alternatively, scan the QR code from your phone to download directly.

